

OVERALL	4490
LIFTERS	
BRACES	
M20 (NF)	50100
20MM REBATE NF	1815
M16 (NF)	100
M16 (FF)	2275
M12 (C)	100.50
16MM C-IN CONDUIT	250
	1615
	250
	2125
	315
	1330
	300
	300
	300
	1330
	315
	1330
	300
	300
	300
	1330
	315
	445
	900
	900
	900
	445
	200
	1595
	300
	300
	300
	1595
	200

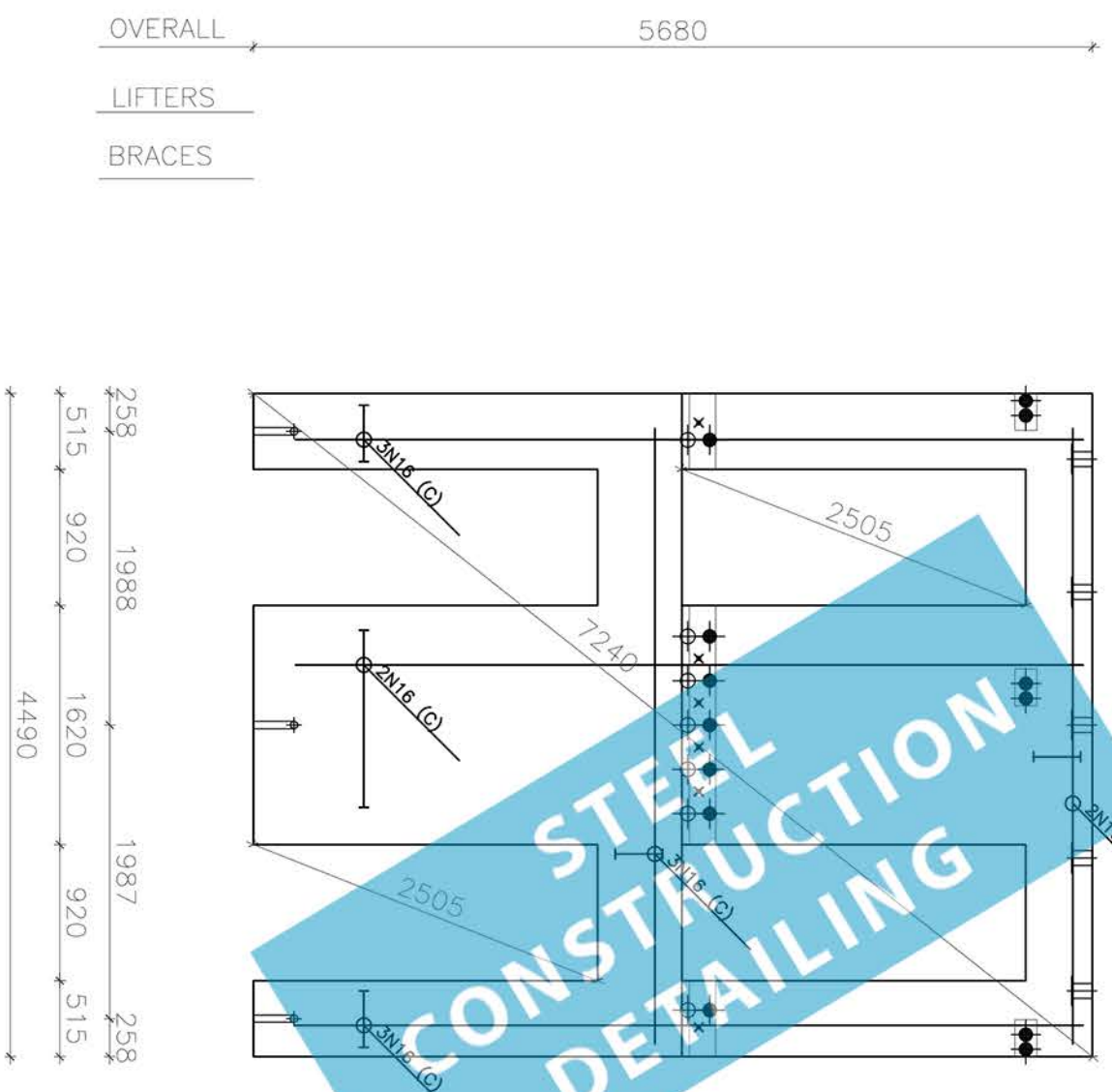

3015	2665	16MM C-IN CONDUIT
2940	2740	M16 (FF)
3090	2590	M16 (NF)
5230	450	M20 (NF)
2950	180	20MM REBATE NF
2900	230	20MM REBATE FF
2330	570	OPENING
5680		OVERALL

50 DIA GROUT TUBE
OPENING
OVERALL



●	B	Brace points
↕	F	Face lifters
↕	E	Edge lifters
		Strong backs during lifting
●		M12 (NF)
		M16 (NF)
		M20 (NF)
		M24 (NF)
⊕		M12 (FF)
		M16 (FF)
		M20 (FF)
		M24 (FF)
		FERRULES (CTR)
		M16 (C)
		M20 (C)
		M24 (C)
○		25MM CONDUIT 150MM LONG
		CAST-IN PLS ALL TO STEEL SHOP DETAIL
		15L82 FABRIC CENTRAL U.N.O. TYPICAL & NOT SHOWN IN PLAN
		M16 TRIMMER TYPICAL U.N.O.
X		EXTRA REINFORCEMENT SET OUT AS SHOWN IN PLAN
		ITEMS TYP PLACED CENTRALLY FOR (C) SET OUT AT 40MM MIN. CONC. COVER U.N.O. DO ALL LAPS & EXTENSIONS AT 600MM TYP. TRIMMERS AT ALL PERIMETERS & OPENINGS
1	No.	NUMBER
150	mm	THICK
16.9	m ²	AREA
2.5	m ³	MASS
6.1	Tonne	WEIGHT

PANEL VIEW INTERNAL U.N.O.
 PANELS 150MM THICK U.N.O.
 DO 20MM CHAMFERS TO EDGES U.N.O.
 SET OUT FOR 20MM VERTICAL JOINTS
 & FOR 20MM HORIZONTAL JOINTS

MARK 70